



# DEPARTMENT OF PLANNING

## Application / Petition Form & Statement of Financial Interest

### Department Use

Case #
Meeting Date
Total Fee
Received By/Date

Case Type (Special Use Permit, Rezoning, Variance, Site Development Plan Review, etc)

Project Address (Location) 8414 Farm Rd #180

Project Name Rental Auto Proposed Use Rental

Assessor's Parcel #(s) 125-17-610-008

Ward # \_\_\_\_\_

General Plan: Existing \_\_\_\_\_ Proposed \_\_\_\_\_ Zoning: Existing \_\_\_\_\_ Proposed \_\_\_\_\_

Additional Information \_\_\_\_\_

Property Owner Farm Road Retail, LLC

Contact Christine Reeves

Address 10655 Park Run Drive #160

City Las Vegas State NV Zip 89144

E-mail creeves@laurichproperties.com

Phone 702-220-4500 x 223

Applicant Shawna Greer

Contact 907-830-8050

Address 2136 Cabrini Ct

City N. Las Vegas State NV Zip 89032

E-mail ClemcoShawna@gmail.com

Phone \_\_\_\_\_

Representative Sanjay Veerka

Contact \_\_\_\_\_

Address 2700 S. Las Vegas Blvd. #3501

City Las Vegas State NV Zip 89109

E-mail Sanjay@axiohomes.com

Phone 224-619-2502

To the best of your knowledge, does the Mayor or any member of the City Council or Planning Commission have any financial interest in this or any other property with the property owner, applicant, the property owner or applicant's general or limited partners, or an officer of their corporation or limited liability company?

☐ Yes

☒ No

If yes, please indicate the member of the City Council or Planning Commission who is involved and list the name(s) of the person or persons with whom the City Official holds an interest. Also list the Assessor's Parcel Number if the property in which the interest is held is different from the case parcel.

City Official \_\_\_\_\_ Partner(s) \_\_\_\_\_

Partner(s) \_\_\_\_\_

I certify that I am the applicant and that the information submitted with this application is true and accurate to the best of my knowledge and belief. I understand that the City is not responsible for inaccuracies in information presented, and that inaccuracies, false information or incomplete application may cause the application to be rejected. I further certify that I am the owner or purchaser (or option holder) of the property involved in the application, or the lessee or agent fully authorized by the owner to make this submission, as indicated by the owner's signature below.

Application will not be deemed complete until the submitted materials have been reviewed by Department of Planning for consistency with the Zoning Ordinance.

Property Owner Signature [Signature]

An authorized agent may sign in lieu of the property owner for Final Maps, Tentative Maps and Parcel Maps

Print Name Richard Gordon, President, Farm Road Retail Mgmt. Co, Inc.

Subscribed and sworn before me

This 26 day of March, 20 2024

Christine Rabala

Notary Public in and for said County and State



**24-0168**  
**CHRISTINE RABALA**  
**NOTARY PUBLIC**  
**STATE OF NEVADA**  
Appt. No. 22-9543-01  
My Appt. Expires: July 16, 2026

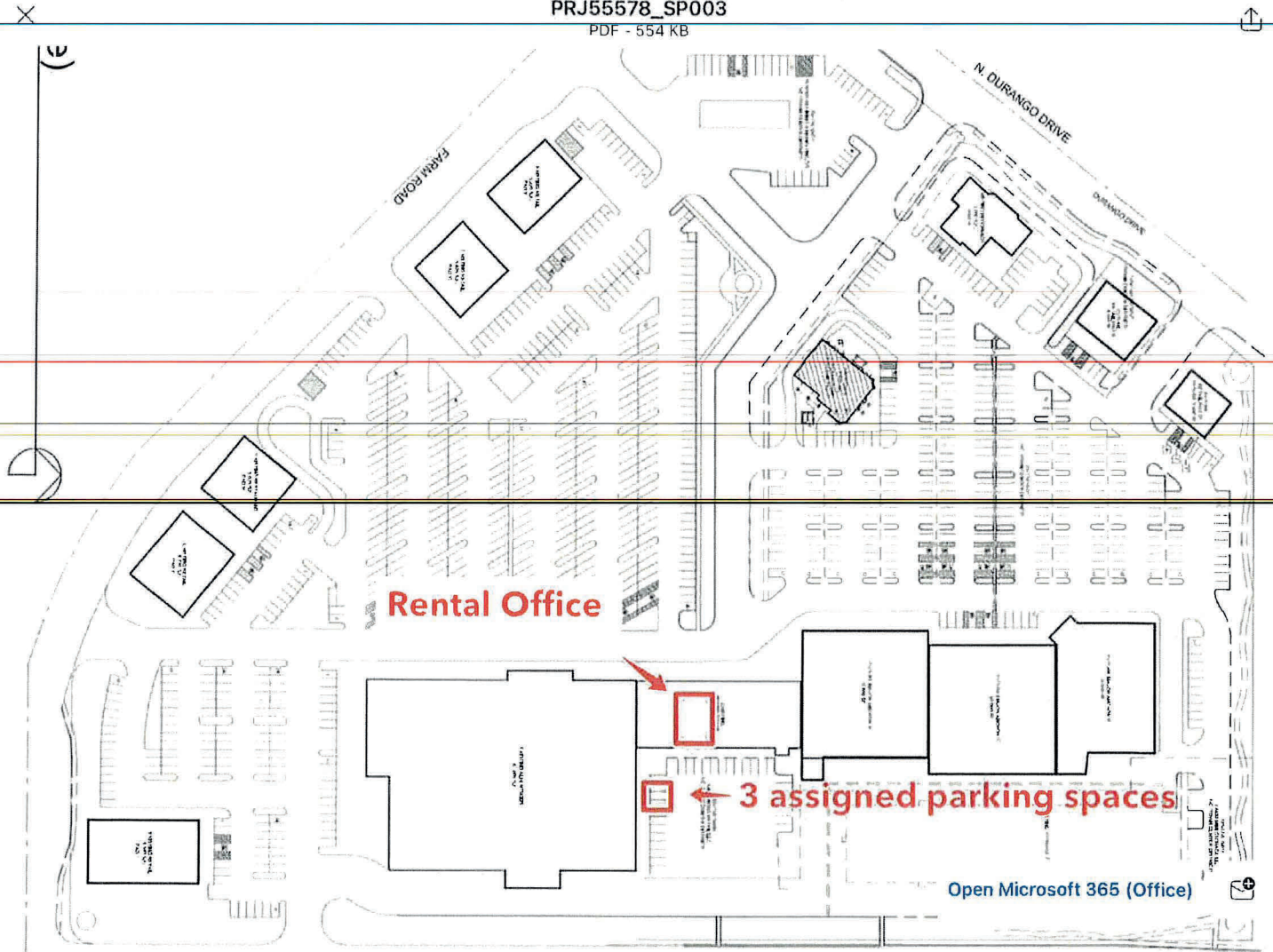

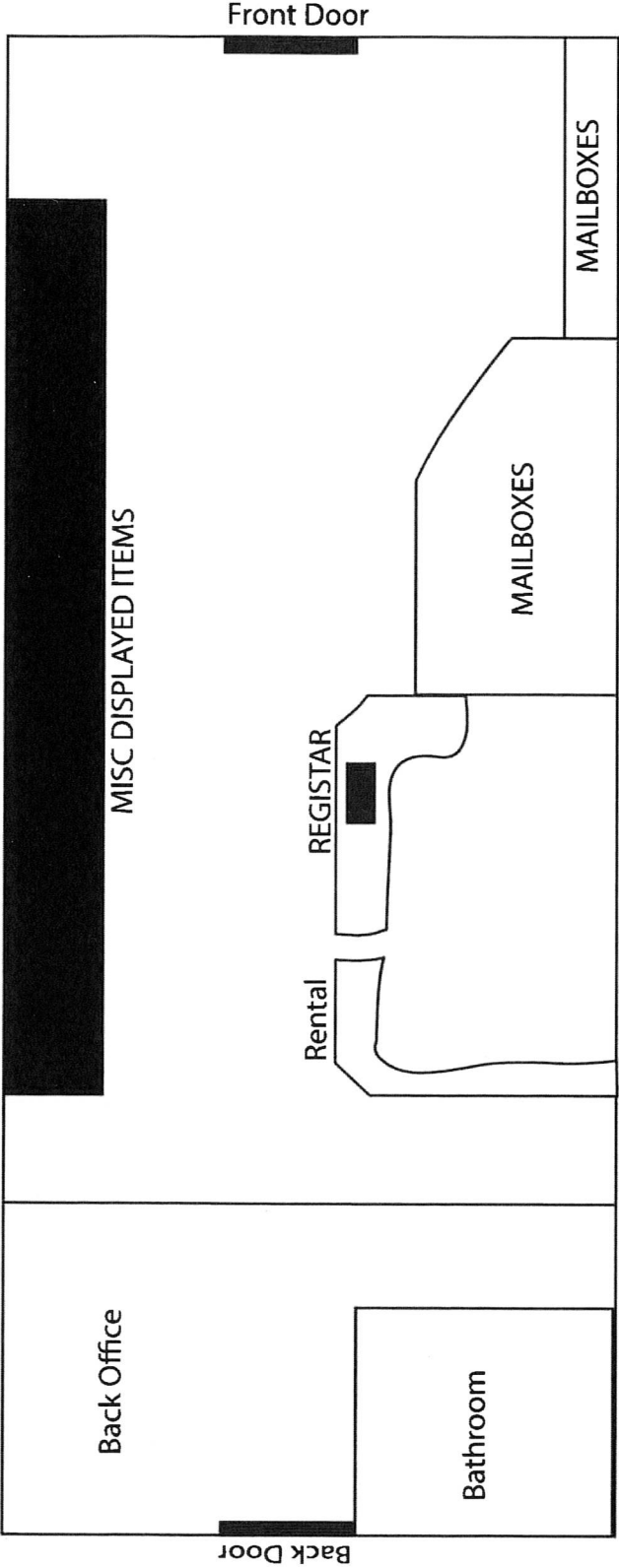

24-0168  
03/27/2024