



DEPARTMENT OF PLANNING

Application / Petition Form & Statement of Financial Interest

Department Use

Case #
Meeting Date
Total Fee
Received By/Date

Case Type (Special Use Permit, Rezoning, Variance, Site Development Plan Review, etc) Rezoning

Project Address (Location) 200 N Lamb Blvd, Las Vegas, NV, 891

Project Name 200 Lamb P-O zoning **Proposed Use** P-O: Professional Office

Assessor's Parcel #(s) 140323 0007 **Ward #** _____

General Plan: Existing R-1 Proposed P-O **Zoning:** Existing R-1 Proposed P-O

Additional Information Requesting change of existing R-1 - Single Family Residential to P-O - Professional Office zoning.

Property Owner Sataray Properties Group LLC **Contact** Justo Sataray

Address 9983 Desert Alcove Rd **City** Las Vegas **State** NV **Zip** 89178

E-mail _____ **Phone** _____

Applicant Fresh General Services LLC **Contact** Guillermo Sataray

Address 7318 W Le Baron Ave **City** Las Vegas **State** NV **Zip** 89178

E-mail guillermo.sm@fgsnv.com **Phone** _____

Representative Fresh General Services LLC **Contact** Guillermo Sataray

Address 7318 W Le Baron Ave **City** Las Vegas **State** NV **Zip** 89178

E-mail guillermo.sm@fgsnv.com **Phone** _____

To the best of your knowledge, does the Mayor or any member of the City Council or Planning Commission have any financial interest in this or any other property with the property owner, applicant, the property owner or applicant's general or limited partners, or an officer of their corporation or limited liability company? ☐ Yes ☒ No

If yes, please indicate the member of the City Council or Planning Commission who is involved and list the name(s) of the person or persons with whom the City Official holds an interest. Also list the Assessor's Parcel Number if the property in which the interest is held is different from the case parcel.

City Official _____ **Partner(s)** _____

Partner(s) _____

- I certify that I am the applicant and that the information submitted with this application is true and accurate to the best of my knowledge and belief. I understand that the City is not responsible for inaccuracies in information presented, and that inaccuracies, false information or incomplete application may cause the application to be rejected. I further certify that I am the owner or purchaser (or option holder) of the property involved in the application, or the lessee or agent fully authorized by the owner to make this submission, as indicated by the owner's signature below.
- Application will not be deemed complete until the submitted materials have been reviewed by Department of Planning for consistency with the Zoning Ordinance.

Property Owner Signature [Signature]

An authorized agent may sign in lieu of the property owner for Final Maps, Tentative Maps and Parcel Maps

Print Name Justo Sataray

Subscribed and sworn before me

This 02 day of April, 2024

Notary Public in and for said County and State

County of Clark, State of Nevada



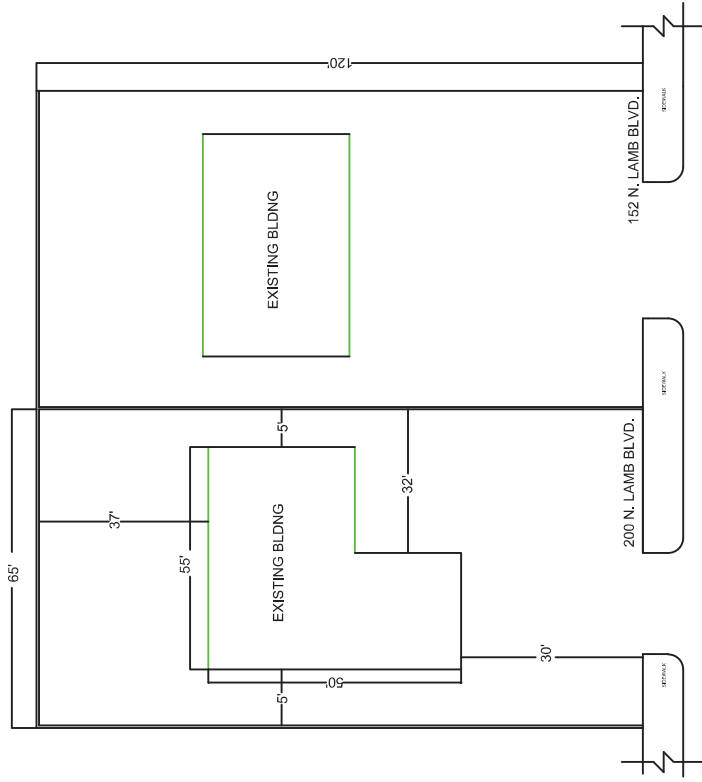

Property Description:	
Lot Dimension	Lot Area
120' X 65'	7,800 sq. ft.
Structure	Dimension
House	15' X 32'
Garage	25' X 18'
	sq. Footage
	1,800 sq. ft.
	4,000 sq. ft.
Total Building Coverage:	
Building Coverage %:	
23,100 sq. ft.	
29,700 sq. ft.	