



DEPARTMENT OF PLANNING

Application / Petition Form & Statement of Financial Interest

Department Use

Case #
Meeting Date
Total Fee
Received By/Date

Case Type (Special Use Permit, Rezoning, Variance, Site Development Plan Review, etc) site development plan review

Project Address (Location) 902 S. Casino Center, Las Vegas, NV 89101

Project Name 902 S. Casino Center Temp Parking Lot **Proposed Use** Temp paid parking

Assessor's Parcel #(s) 13934410032 **Ward #** 3-Diaz

General Plan: Existing C-2 Proposed C-2 **Zoning:** Existing C-2 Proposed C-2

Additional Information _____

Property Owner 900-932 Casino Center LLC **Contact** Kim Marvin Plencner

Address 1000 Royce Blvd **City** Oakbrook Terr **State** IL **Zip** 60181

E-mail ibtag@aol.com **Phone** 630-268-4000

Applicant 900-932 Casino Center LLC **Contact** Kevin M. Plencner

Address 321 S. Casino Center **City** Las Vegas **State** NV **Zip** 89101

E-mail kvplncn@aol.com **Phone** 847-609-4663

Representative Kevin M. Plencner **Contact** Kevin M. Plencner

Address 321 S. Casino Center **City** Las Vegas **State** NV **Zip** 89101

E-mail kvplncn@aol.com **Phone** 847-609-4663

To the best of your knowledge, does the Mayor or any member of the City Council or Planning Commission have any financial interest in this or any other property with the property owner, applicant, the property owner or applicant's general or limited partners, or an officer of their corporation or limited liability company? ☐ Yes ☒ No

If yes, please indicate the member of the City Council or Planning Commission who is involved and list the name(s) of the person or persons with whom the City Official holds an interest. Also list the Assessor's Parcel Number if the property in which the interest is held is different from the case parcel.

City Official _____ **Partner(s)** _____

Partner(s) _____

- I certify that I am the applicant and that the information submitted with this application is true and accurate to the best of my knowledge and belief. I understand that the City is not responsible for inaccuracies in information presented, and that inaccuracies, false information or incomplete application may cause the application to be rejected. I further certify that I am the owner or purchaser (or option holder) of the property involved in the application, or the lessee or agent fully authorized by the owner to make this submission, as indicated by the owner's signature below.
- Application will not be deemed complete until the submitted materials have been reviewed by Department of Planning for consistency with the Zoning Ordinance.

Property Owner Signature

An authorized agent may sign in lieu of the property owner for Final Maps, Tentative Maps and Parcel Maps

Print Name Kim M Plencner

Subscribed and sworn before me

This 22nd day of June, 2022

Notary Public in and for said County and State



VICINITY MAP

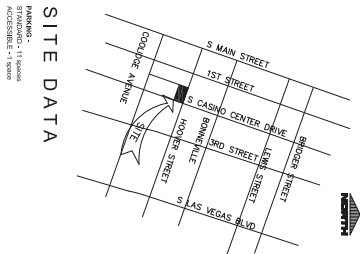

SITE DATA

PARKING - 11 SPACES
STANDARD - 11 SPACES
ACCESSIBLE - 1 SPACE

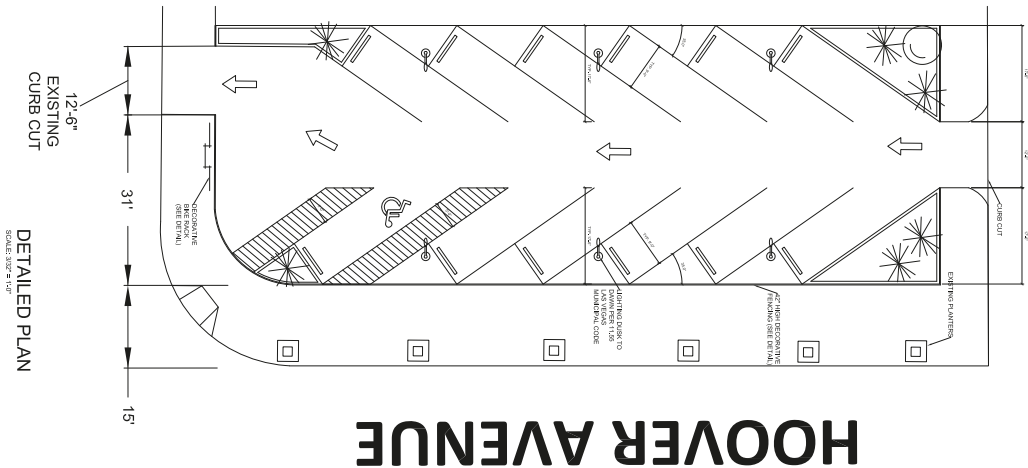

HOOVER AVENUE

TEMPORARY PUBLIC PARKING LOT PERMIT APPLICATION
902 S CASINO CENTER BLVD, LAS VEGAS, NV 89101

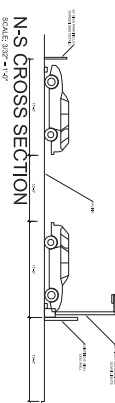
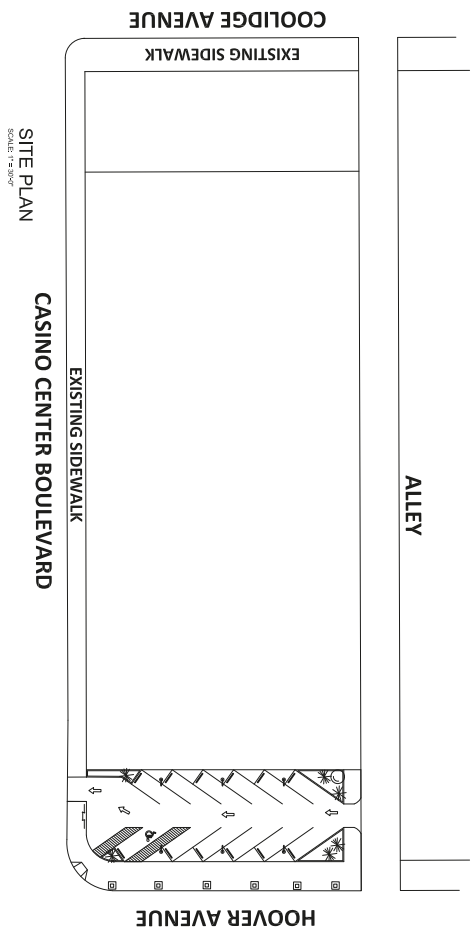

PARKING LOT SCREEN DETAIL
ALONG HOOVER ST. & COOLIDGE AVE.
NOT TO SCALE

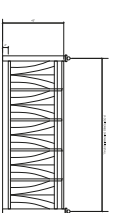

EXAMPLE OF
DECORATIVE BIKE RACKS
NOT TO SCALE



22-0298

902 SOUTH
CASINO CENTER
BOULEVARD
LAS VEGAS, NV
89101
APN#139-34-10-038

Drawings as Instruments of Service are the sole property of the signing Contractor, and any use or reproduction in whole or in part without his written consent is strictly prohibited.
Drawings and Specifications remain the property of the Design Professional and shall not be used for any other project without his written consent. These drawings may be used only for the use intended and shall not be used for any other purpose without his written consent. They were prepared and not for the construction of any other project.

PROJECT NUMBER: 00000
PROJECT MANAGER: KEVIN M. KLECKEN
ARCHITECT: AS NOTED
SCALE: AS NOTED
DRAWN BY: CHECKED BY:
NO. DATE REVISIONS/ISSUES
1. THESE PLANS ARE PREPARED & SUBMITTED BY THE CONTRACTOR AS AN EXEMPTION TO REG. 52.300 CATEGORY AUTHORIZED UNDER REG. 504.

OWNER
902-332 CASINO CENTER, LLC
1000 Boyd Street, Suite 1100
Las Vegas, NV 89101
Kevin M. Klecken
331 S Casino Center Suite #100
Las Vegas, NV 89101
(702) 899-4868

T1.0
PROJECT DATA,
SITE PLAN, DETAILED PLAN,
CROSS SECTION,
SCREEN DETAIL

TEMPORARY PUBLIC PARKING LOT PERMIT APPLICATION
902 S CASINO CENTER BLVD, LAS VEGAS, NV 89101

HOOVER AVENUE

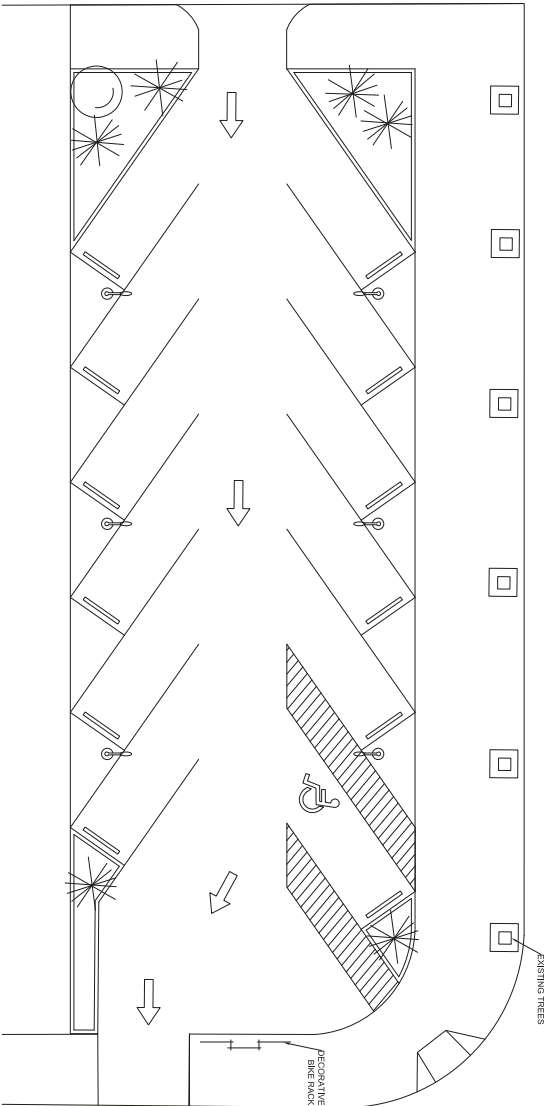

LANDSCAPE PLAN

SCALE: 1/8" = 1'-0"

LANDSCAPE SCHEDULE

SYMBOL	COMMON NAME	BOTANICAL NAME	SIZE
1	DELETERIOUS DATE PALM	PHOENIX DACTYLIFERA VEGEY MOORE	25 CT
2	SHRUBBING ACACIA	ACACIA STENOPHYLLA	25 CT

OWNER
902-SOUTH CASINO CENTER, LLC
1000 Boyd Street
Las Vegas, NV 89101
Kevin M. Thompson
371 S Casino Center Suite #100
Las Vegas, NV 89101
(702) 599-4830

SCALE

22-0298

902 SOUTH
CASINO CENTER
BOULEVARD
LAS VEGAS, NV
89101
APN#139-34-410-038

Drawings as Instruments of Service are the sole property of the signing Contractor, and any use or reproduction in whole or in part without his written consent is strictly prohibited.
Drawings and Specifications remain the property of the Design Professional and shall not be used for any other project without the written consent of the Design Professional.
These drawings may be used only for the project and site for which they were prepared and not for any other project or site without the written consent of the Design Professional.

NO. DATE REVISIONS
1. THESE PLANS ARE PREPARED AND SUBMITTED BY THE CONTRACTOR AS AN EXEMPTION TO REG. 52.300 CATEGORY AUTHORIZED UNDER REG. 504.

CONTRACTOR SIGNATURE

PROJECT NUMBER: 00000
PROJECT MANAGER: KEVIN M. THOMPSON
ARCHITECT: AS NOTED
SCALE: AS NOTED
DRAWN BY:
CHECKED BY:

T2.1
LANDSCAPE PLAN