

Survey Catalog

- The City of Las Vegas Historic Resource Survey Catalog
- Historic resources surveys and reports previously conducted within the city limits of Las Vegas
- Completed March 2022
- Data from 120 surveys used to create maps illustrating surveyed areas





CITY OF LAS VEGAS HISTORIC RESOURCE CATALOG

PREPARED BY NEVADA PRESERVATION FOUNDATION

City of Las Vegas

Historic Surveys
- Citywide Map -

 Surveied area
4,176 acres

 City of Las Vegas
90,878 acres

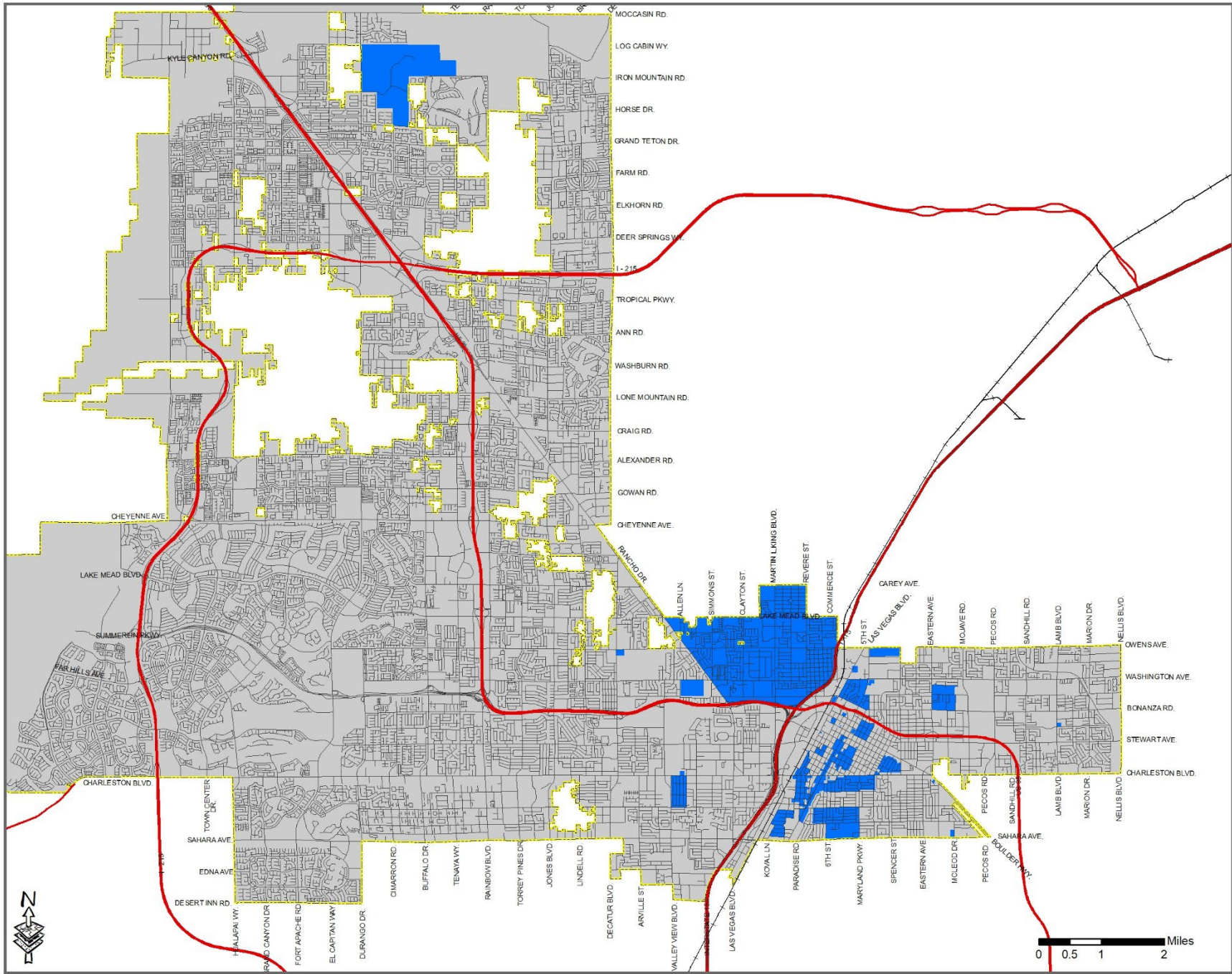

Printed: Monday, April 25, 2022



GIS maps are normally produced
only to meet the needs of the City.
Due to continuous development activity
this map is for reference only.
Geographic Information System
Planning & Development Dept
702-229-6301

*Historic Surveys
- Citywide Map -*

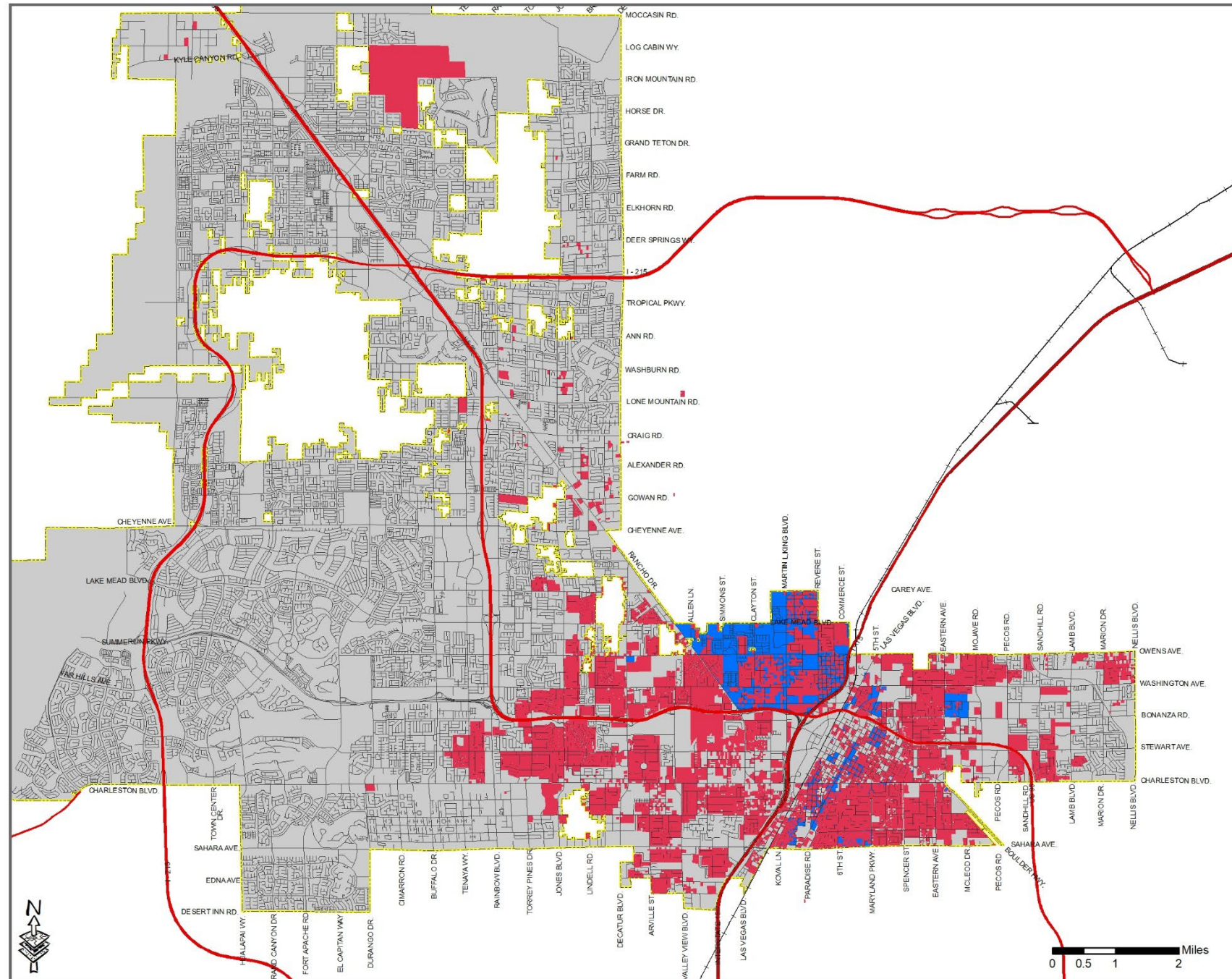



GIS maps are normally produced only to meet the needs of the City. Due to continuous development activity this map is for reference only.

Geographic Information System
Planning & Development Dept.
702-229-6301

City of Las Vegas

Historic Surveys
- City center map -

-  Surveyed area
4,176 acres
-  City of Las Vegas
90,878 acres

Printed: Monday, April 25, 2022





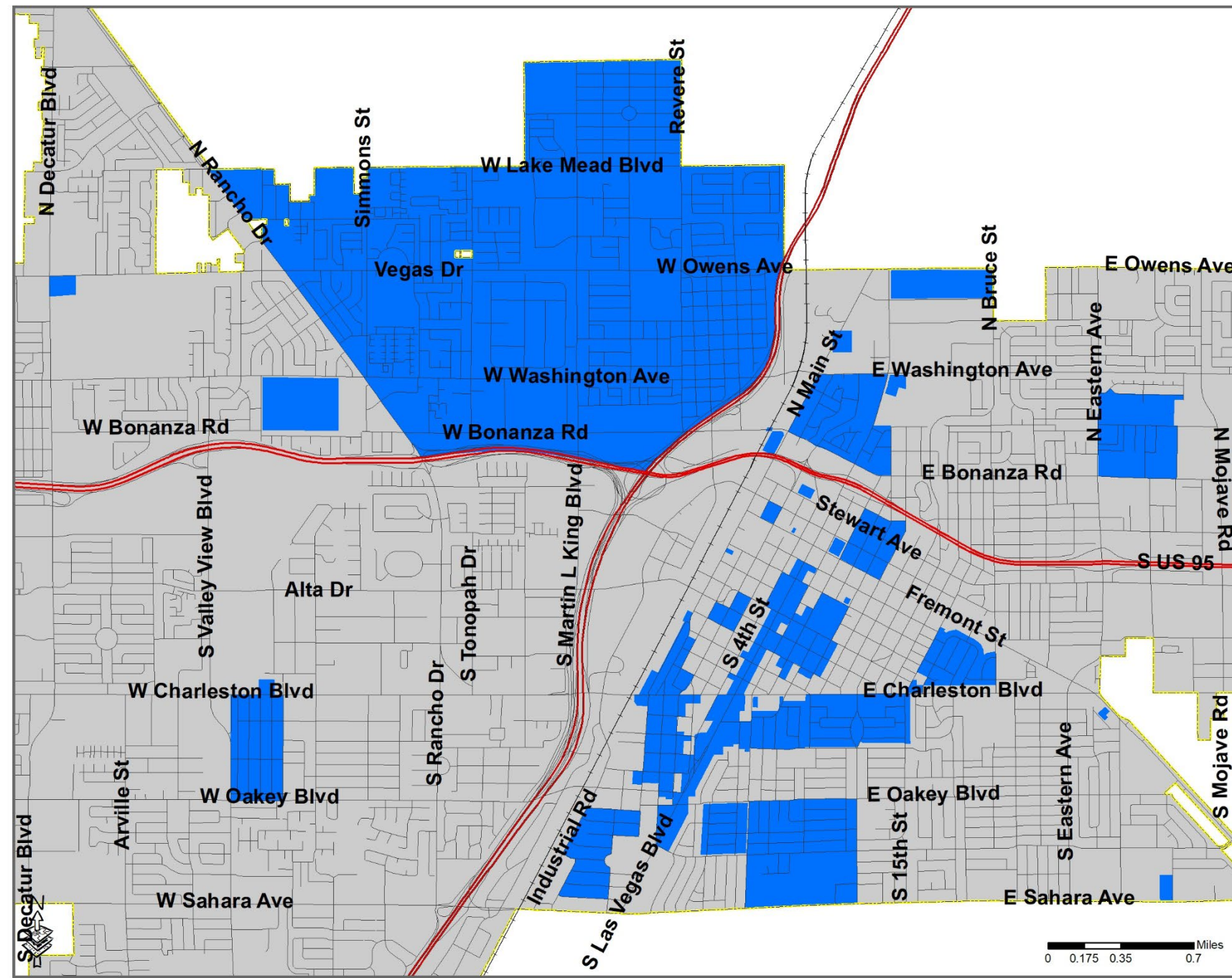

GIS maps are normally produced
only to meet the needs of the City.
Due to continuous development activity
this map is for reference only.
Geographic Information System
Planning & Development Dept
702-229-6301

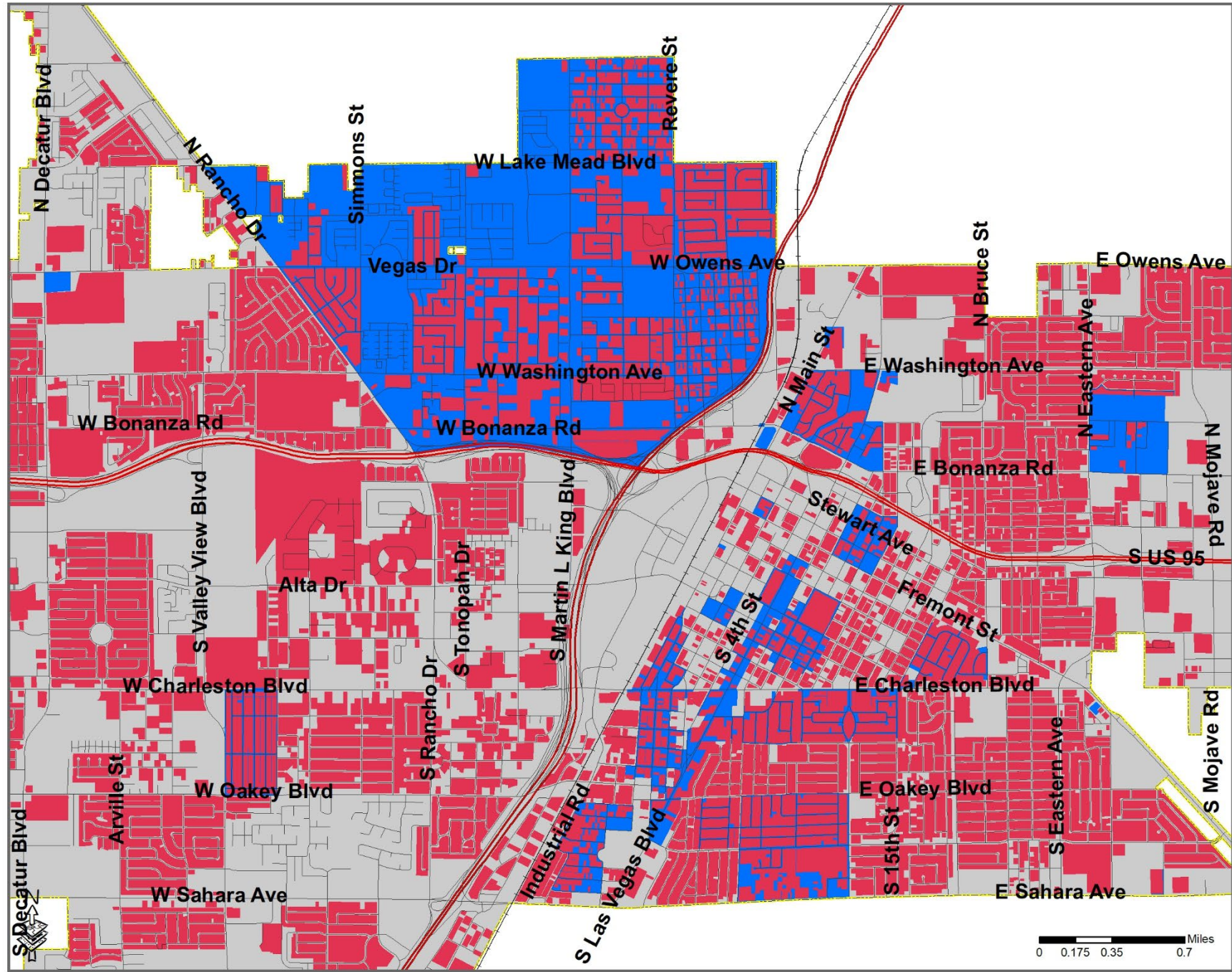

City of Las Vegas

Historic Surveys
- City center map -

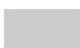

-  Surveyed area
4,176 acres
-  City of Las Vegas
90,878 acres
-  Parcel construction
year 1972 or earlier

Printed: Monday, April 25, 2022



GIS maps are normally produced
only to meet the needs of the City.
Due to continuous development activity
this map is for reference only.
Geographic Information System
Planning & Development Dept.
702-229-6301

City of Las Vegas

City Wide Historic Preservation map

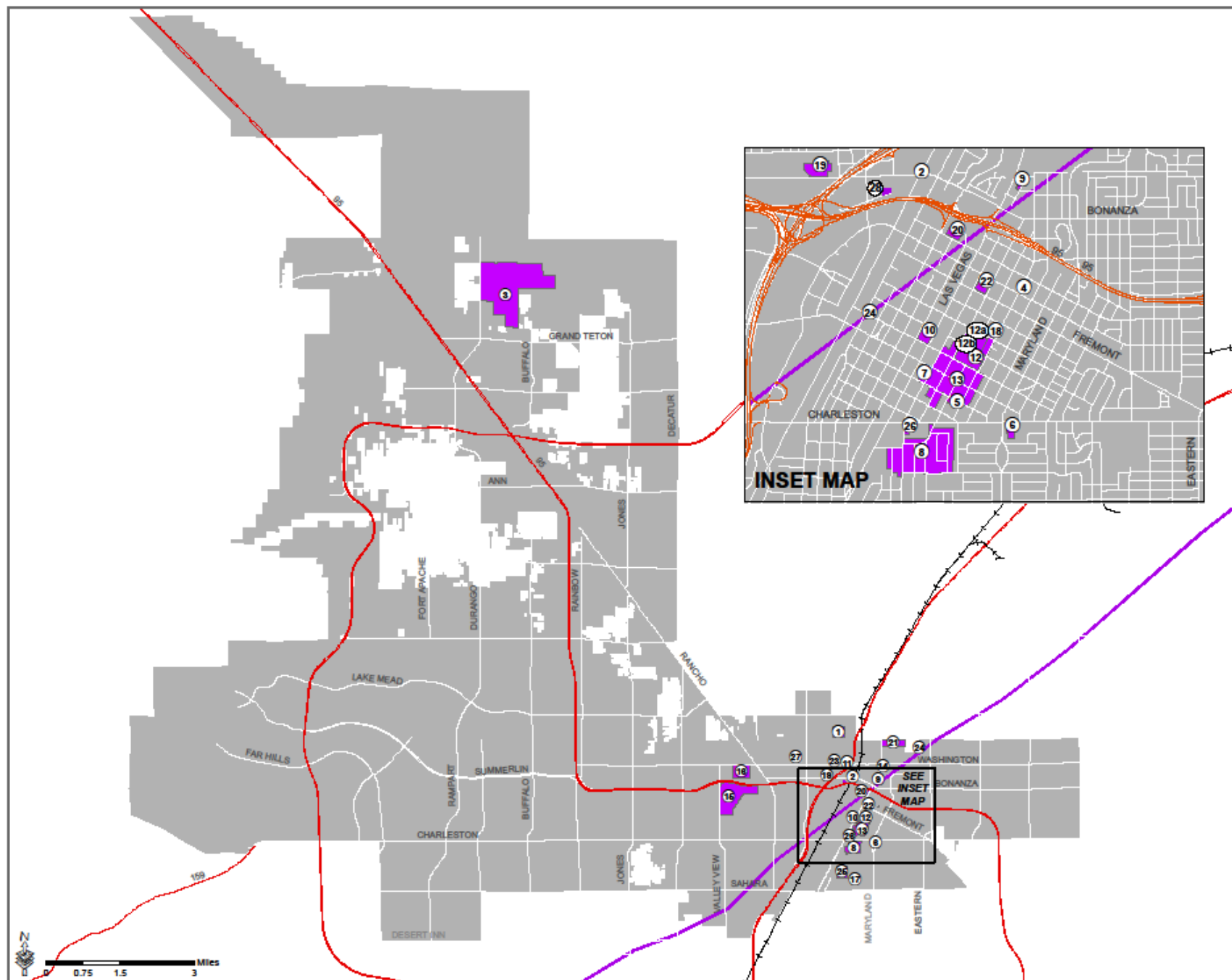

- 1, Berkley Square Neighborhood Historic District
- 2, Bonanza Underpass
- 3, Floyd Lamb Park at Tule Springs Ranch
- 4, Frank Walt House
- 5, The Henderson House
- 6, Huntridge Theater
- 7, Jay Dayton Smith House
- 8, John S. Park Historic District
- 9, La Concha Motel Lobby
- 10, Fifth Street School
- 11, Westside School
- 12, Las Vegas High School Historic District
- 12a, Las Vegas High School Academic Building and Gymnasium
- 12b, Las Vegas High School Frazier Hall
- 13, Las Vegas High School Neighborhood District
- 14, Las Vegas Mormon Fort
- 15, Big Springs/Las Vegas Springs
- 16, Lorenzi Park Historic District
- 17, Mesquite Club
- 18, Morelli House
- 19, Moulin Rouge Hotel and Casino*
- 20, U.S. Post Office and Courthouse
- 21, Woodlawn Cemetery
- 22, El Cortez Hotel and Casino
- 23, Harrison Boarding House
- 24, Old Spanish Trail
- 25, Beverly Green Historic District
- 26, Wengert House
- 27, Helen Toland Residence
- 28, Mesquitewood
- 29, Eureka Locomotive (address restricted)
- 30, Tule Springs Archaeological Site (address restricted)
- 31, Green Shack*
- 32, Railroad Cottage Historic District**

Properties marked with a * no longer exist, having either burned down or been demolished.
Properties marked with a ** are no longer historically listed as they have moved from their original location.



GIS maps are normally produced only to meet the needs of the City. Due to continuous development activity this map is for reference only.
Geographic Information Systems
Planning & Development Dept.
702-228-4301

Survey Catalog

- The City of Las Vegas Historic Resource Survey Catalog
- Historic resources surveys and reports previously conducted within the city limits of Las Vegas
- Completed March 2022
- Data from 120 surveys used to create maps illustrating surveyed areas



CITY OF LAS VEGAS
HISTORIC RESOURCE
CATALOG

PREPARED BY NEVADA PRESERVATION FOUNDATION