



# DEPARTMENT OF PLANNING

## Application / Petition Form & Statement of Financial Interest

Department Use

Case #
Meeting Date
Total Fee
Received By/Date

**Case Type** (Special Use Permit, Rezoning, Variance, Site Development Plan Review, etc) Special Use Permit on selling full alcohol (including liquor)

**Project Address** (Location) 921 W Owens Ave, Suite 170

**Project Name** 921 W Owens Ave, Suite 170 - Banquet Hall - Full Alcohol **Proposed Use** Banquet Hall

**Assessor's Parcel #(s)** 13928517001 **Ward #** 5

**General Plan:** Existing \_\_\_\_\_ **Proposed** \_\_\_\_\_ **Zoning:** Existing (T-4 Corridor) **Proposed** \_\_\_\_\_

**Additional Information** The application is for an Alcohol, On-Premise Full use at 921 West Owens, Suite 170.

**Property Owner** DEVARIM 18 LLC **Contact** \_\_\_\_\_  
**Address** 1300 W OLYMPIC BLVD # 500 **City** LOS ANGELES **State** CA **Zip** 90015  
**E-mail** \_\_\_\_\_ **Phone** \_\_\_\_\_

**Applicant** RAY KOROGHLI **Contact** \_\_\_\_\_  
**Address** 3055 VIA SARAFINA DR **City** HENDERSON **State** NV **Zip** 89052  
**E-mail** \_\_\_\_\_ **Phone** \_\_\_\_\_

**Representative** EDGAR MONTALVO **Contact** \_\_\_\_\_  
**Address** 2209 TOSCA STREET #8-101 **City** LAS VEGAS **State** NV **Zip** 89128  
**E-mail** comments@xpconsult.net **Phone** (702)479-8664

To the best of your knowledge, does the Mayor or any member of the City Council or Planning Commission have any financial interest in this or any other property with the property owner, applicant, the property owner or applicant's general or limited partners, or an officer of their corporation or limited liability company? ☐ Yes ☒ No

If yes, please indicate the member of the City Council or Planning Commission who is involved and list the name(s) of the person or persons with whom the City Official holds an interest. Also list the Assessor's Parcel Number if the property in which the interest is held is different from the case parcel.

**City Official** \_\_\_\_\_ **Partner(s)** \_\_\_\_\_

**Partner(s)** \_\_\_\_\_

- I certify that I am the applicant and that the information submitted with this application is true and accurate to the best of my knowledge and belief. I understand that the City is not responsible for inaccuracies in information presented, and that inaccuracies, false information or incomplete application may cause the application to be rejected. I further certify that I am the owner or purchaser (or option holder) of the property involved in the application, or the lessee or agent fully authorized by the owner to make this submission, as indicated by the owner's signature below.
- Application will not be deemed complete until the submitted materials have been reviewed by Department of Planning for consistency with the Zoning Ordinance.

**Property Owner Signature** \_\_\_\_\_  
 An authorized agent may sign in lieu of the property owner for Final Maps, Tentative Maps and Parcel Maps

**Print Name** RAY KOROGHLI

Subscribed and sworn before me

This MANAGER day of SEPTEMBER-21, 2022

Cindy L. Long Clark and Nevada  
 Notary Public in and for said County and State County STATE

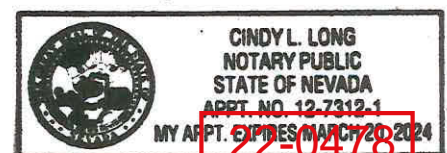

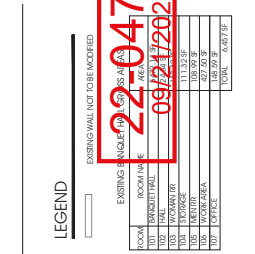

[illegible]

THE MEASUREMENTS HERE PROVIDED ARE THE RESULT OF A FIELD SURVEY AND THE RUNS IN RECORDS.